

# KT80

Quick Guide

Android 5.1



## Catalog

KT80 SPECIFICATIONS.....	2
External structure.....	5
Overall .....	5
Android 5.1 introduction.....	6
System lock screen .....	6
Main interface .....	7
All applications .....	8
Basic application and settings .....	9
Phone.....	9
Camera .....	10
Set the language.....	10
A key scan.....	12
Include key-values .....	13
Include key.....	13
Instructions.....	14
RFID Read (optional).....	15
Basic model description .....	15
Special custom instructions.....	16
Technical Support Contact .....	16

## KT80 SPECIFICATIONS

Basic parameters	
CPU	ARM Cotex-A53 8-core 1.5GHz
OS	Android 5.1
RAM	2GB
ROM	16GB
Storage Extensions	Two SD card slots, maximum support 128GB.
Keyboard	10side button , two power key
Battery	13600mAh 3.8V, Standby time of 25days, 17hours of continuous work time.
Charging method	Support fast charge and Magnetic charge, Special quick charge, Voltage: 5V/9V , Electric current: 1.6A
Wireless transmission	1. Bluetooth V2.1+ EDR/ V3.0+ HS/ V4.1
	2. WIFI 802.11 b/g/n/a 2.4G/5G
	3. GPRS/EDGE/HSPA/CDMA2000/TDD/FDD
Location service	GPS, AGPS, BEIDOU (accuracy of < 10 meters, positioning time<40s).
Notification Method	Sound, vibration, LED
Audio	Built-in speaker
Size	270mm*176mm*20mm
Weight(with battery)	850g
Machine performance	
Operating temperature	Normal operating temperature -20℃ to 60℃, low temperature battery -30℃.
Storage temperature	-40 ℃ ~ 75℃
Humidity	5%-95%(no condensing)
Humidity	IP65
Drop test	6 surface can withstand 1.8 meter drops to concrete floor of the impact.
Rolling test	Rolling specifications : 0.5 m / 1000 times (6 contact surfaces)
Electrostatic discharge (ESD)	± 15kV air discharge, ± 8kV contact discharge
Camera	
Pixel	Rear 13 million pixels; front 5 million pixels.
Focus mode	Rear auto focus, pre fixed focus.
Flash	Support flash, support flashlight.
Display	

Display	8 inch liquid crystal display
Screen resolution	720p(1024*768)
Touchscreen type	Capacitive touch screen(Optional electromagnetic panel)
Back lighting	LED
<b>Network</b>	
Network type	Dual card dual , 4G Full Netcom
Support band	4G TDD-LTE : 1900/2300/2500/2600 MHz(B38/B39/B40/B41)
	4G FDD-LTE : 1800/2100/2600 MHz (B1/B3/B7)
	3G TD-SCDMA: 1900/2100 MHz (B34 B39 )
	3G WCDMA:850/900/1900/2100 MHz(B1 B2 B5 B8)
	2G GSM:850/900/1800/1900 MHz(B2 B3 B5 B8)
	CDMA&EVDO: 800 MHz(BC0)
Communication speed	FDD: Downlink: 150Mbps Uplink: 50Mbps
	TDD: Downlink: 150Mbps Uplink: 50Mbps
	WCDMA HSDPA: Downlink: 42.2Mbps Uplink: 11.5Mbps
	TD-SCDMA: Downlink: 384Kbps Uplink: 384Kbps
	TD-HSDPA: Downlink: 2.2Mbps Uplink: 2.8Mbps
	CDMA2000 1xRTT : 153.6Kbps
	CDMA2000 HRPD/1xEV-DO : Forward link 3.1Mbps Reverse link 1.8Mbps
<b>Scalability</b>	
Physical interface	Two Micro SD card slots, two SIM card slots.
	Micro USB interface, 3.5mm headphone jack, can support RS232/485 serial ports.
Scanning head reading distance	5cm-40cm according to different barcode size and resolution.
Barcode scanning supports barcode type	AZTEC、CODABAR、CODE11、CODE128、EAN128、CODE39、CODE49、CODE93、COMPOSITE、DATAMATRIX、EAN8、EAN13、INT25、MAXICODE、MICROPDF、PDF417、POSTNET、OCR、QR、RSS、UPCA、UPCE、ISBT、BPO、CANPOST、AUSPOST、IATA25、CODABLOCK、JAPOST、PLANET、DUTCHPOST、MSI、TLC39、TRIOPTIC、CODE32、STR25、MATRIX25、PLESSEY、CHINAPOST、KOREAPOST、TELEPEN、CODE16K、POSCODE、COUPONCODE、USPS4CB、IDTAG、LABELIV、LABELV、GS1_128、HANXIN、GRIDMATRIX
RFID	1. High Frequency : 13.56MHz Supported protocols : 14443A, 15693, NFC Reading distance : 0cm-5cm
	2.UHF :UHF 900MHz Support reading and writing(Need to install the extension clip EM55)

	<p>Support EPC C1 GEN2/ISO18000-6C agreement            Tag processing speed &gt;200/s, Reading distance 0-5m            Tag processing speed &gt;200/s, Reading distance 0-5m</p>
	<p>3.ID card: 13.56MHz            Support the second generation ID card to read the complete information and analysis, does not require networking.</p>
Infrared module (optional)	<p>Power infrared meter reading module, 38kHz modulation frequency, 940nm, and in line with the meter DLT 645-2007 standard DLT 645-2007</p>
Fingerprint Module (optional)	<p>Semiconductor fingerprint identification(Ordinary civil: 1000fingerprints storage, 1:1000&lt;1s; FBI STQC special: 100fingerprint storage, 1:100&lt;2s).</p>
<b>Accessories</b>	
Standard Accessories	<p>Magnetic charging line, USB data cable, Special fast charger.</p>
Optional Accessories	<p>Metal base, Wristband, Magnetic bracket</p>

## External structure

### Overall

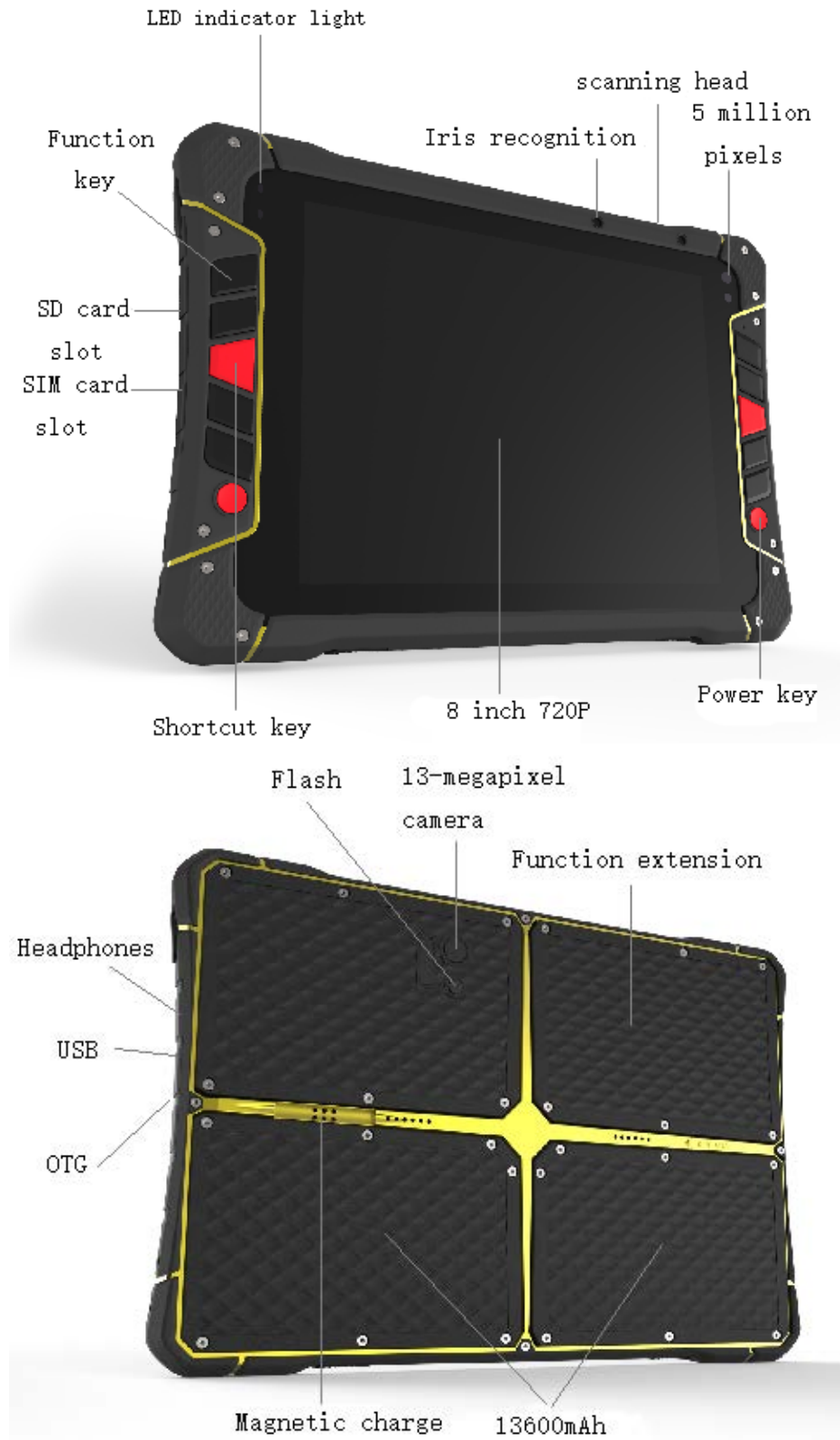

## Android 5.1 introduction

### System lock screen

If you don't have a screen lock, you can unlock it, open an app, and view notification.

**Quick Setup:** Touch the screen to the top position and slide the notification bar, directly touching the icons setting, but also directly touch the top of the System Setup icon to enter system settings.

**Notice:** Double-click to expand, touch to view press and hold the left and right point slide removed.

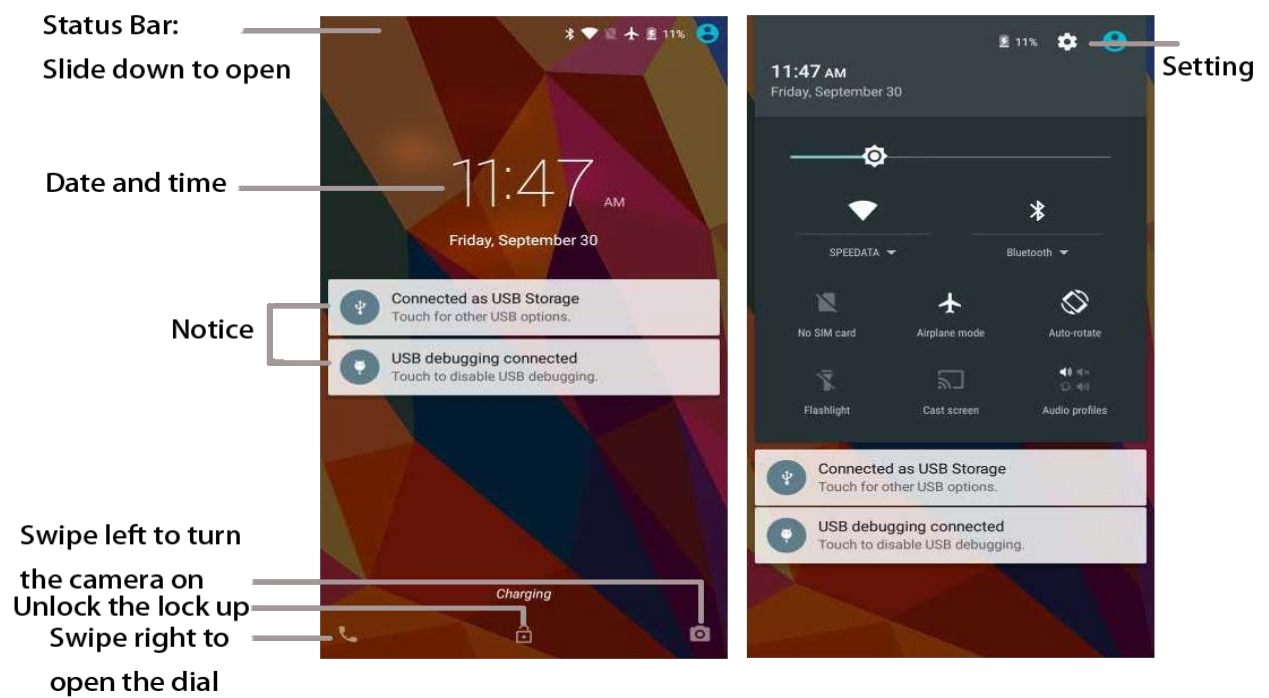

## Main interface

In the main interface, you can observe the state, view the notification, open the application, such as search.

**Add application shortcuts:** Point hold the app icon and then move to the main screen anywhere.

**Settings:** Change screen brightness, WLAN, etc. Can be directly slide down the status bar, quick operation settings.

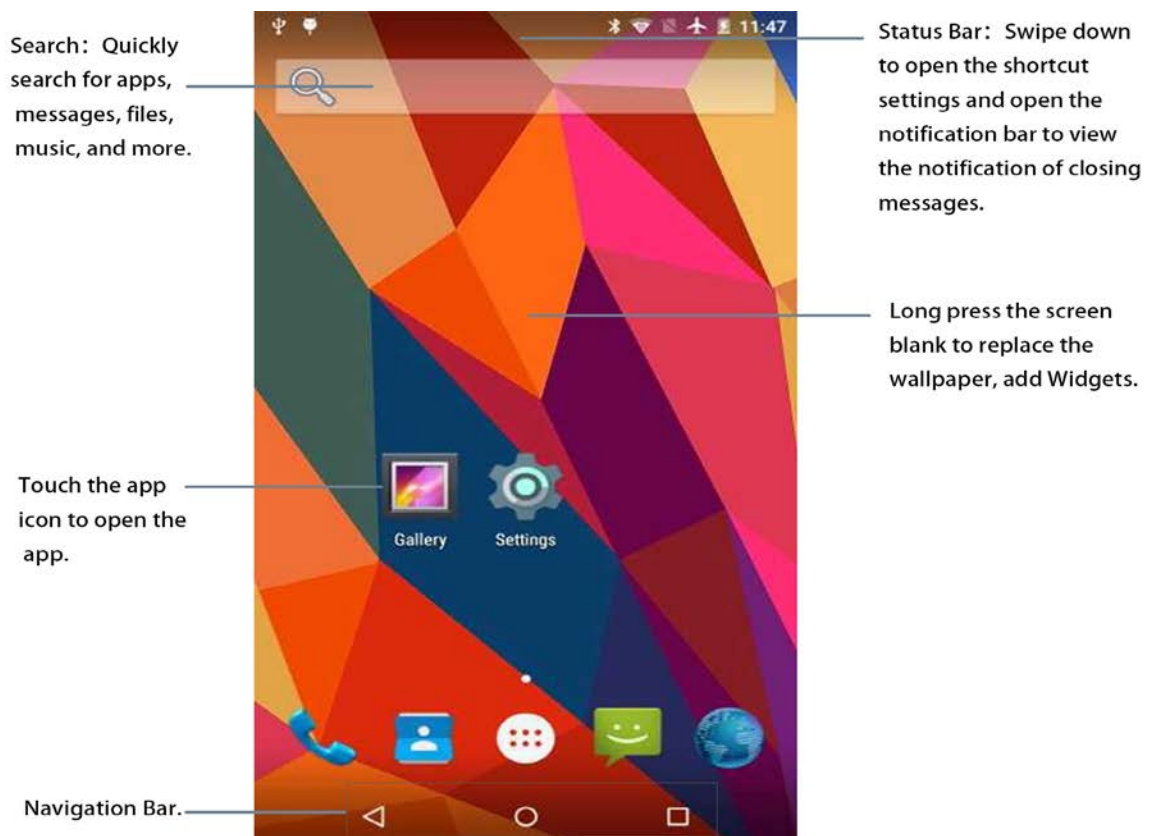



## All applications

Touch the “All app icon” in the Favorites bar to see all of the apps already installed on your current device.

Swipe the screen left or right to see all your apps.

Touch the icon to open the app.

Tap and hold the icon to add a shortcut to the Home screen, to view the application information, or to uninstall it (The system application can only view the application information).

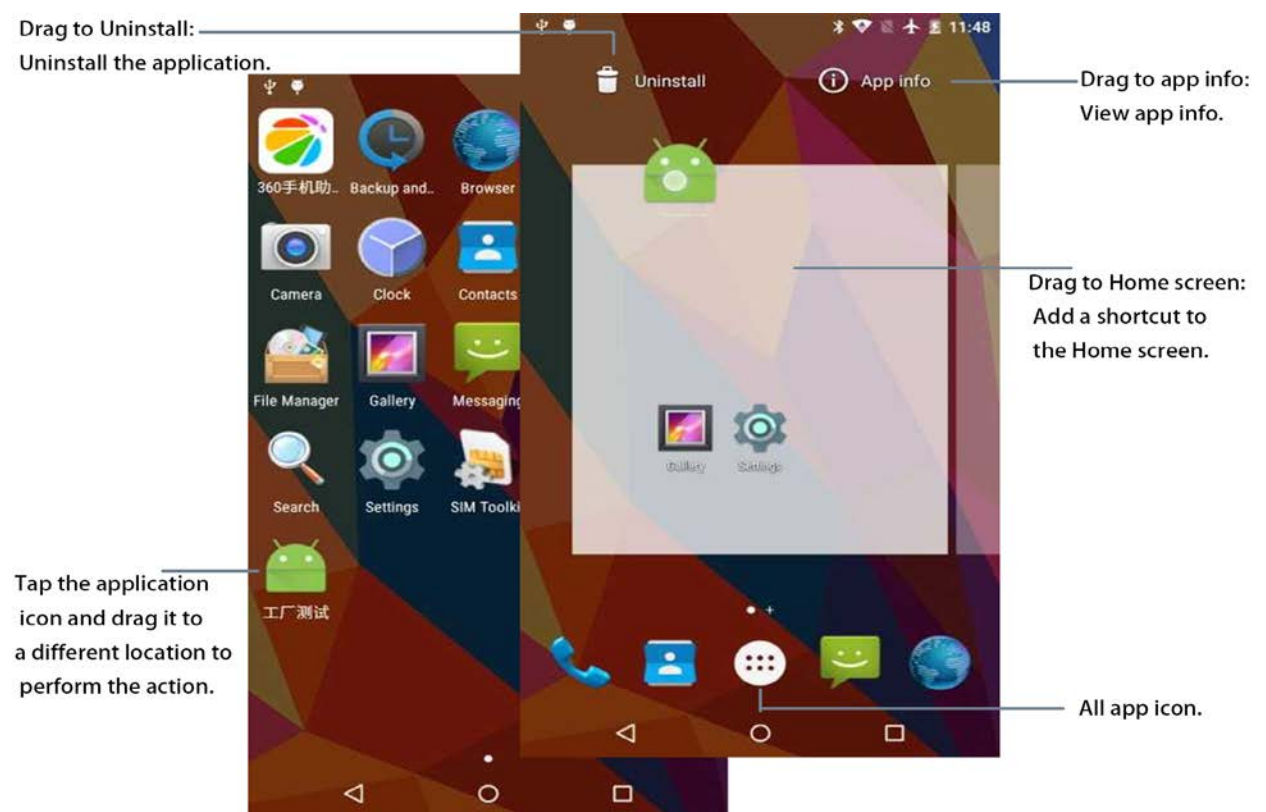

## Basic application and settings

### Phone

**Favorites bar** or touch **the phone icon in all applications** , or slide the screen to the right to enter the dial screen interface can use the phone function.

**Speed Dial:** Shows stored in your phone, and favorite contacts.

**Outbound dialing:** Dial opening disk, use the virtual dial pad to enter or use the hardware keyboard to enter the number.

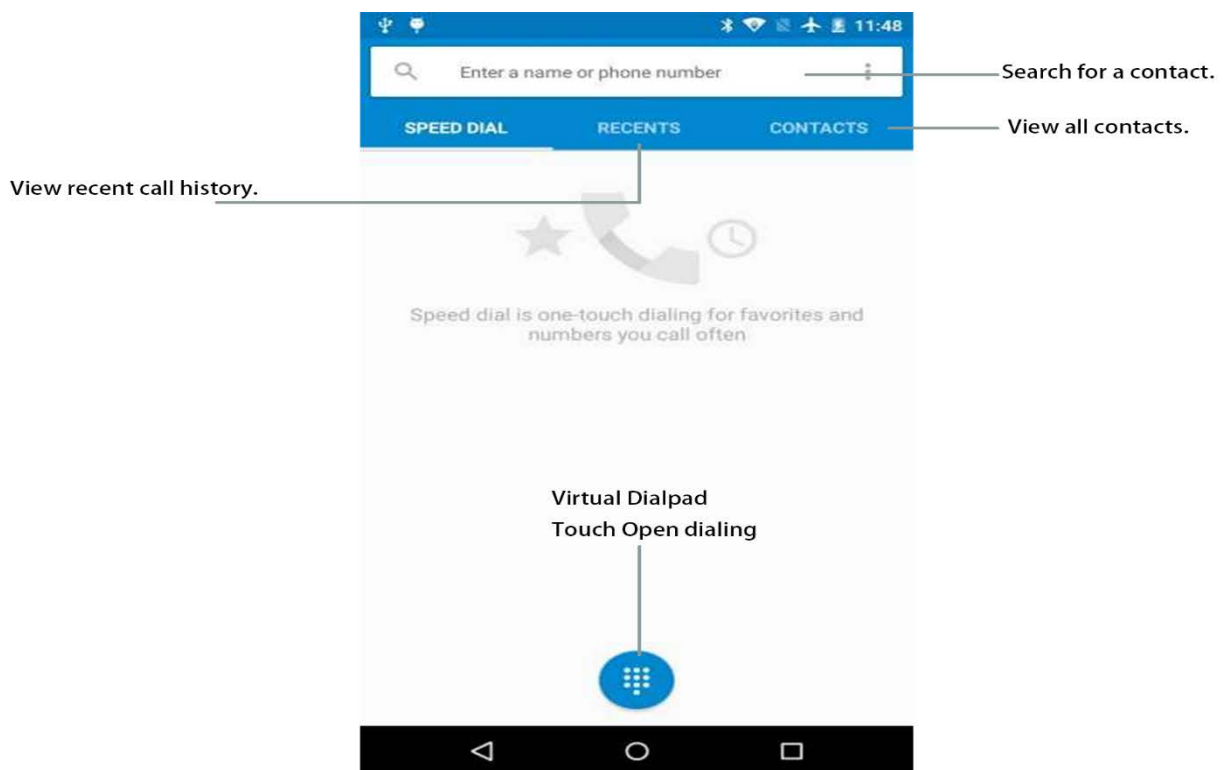

## Camera

There are three ways to turn the camera on: the screen lock screen to left, touch the camera application icon, and press the camera shortcut key (on both sides of the screen).

**Snapshot Mode:** Swipe left or right to see more pictures mode.

**Flash modes:** automatic, always on, and always off three modes, default mode.

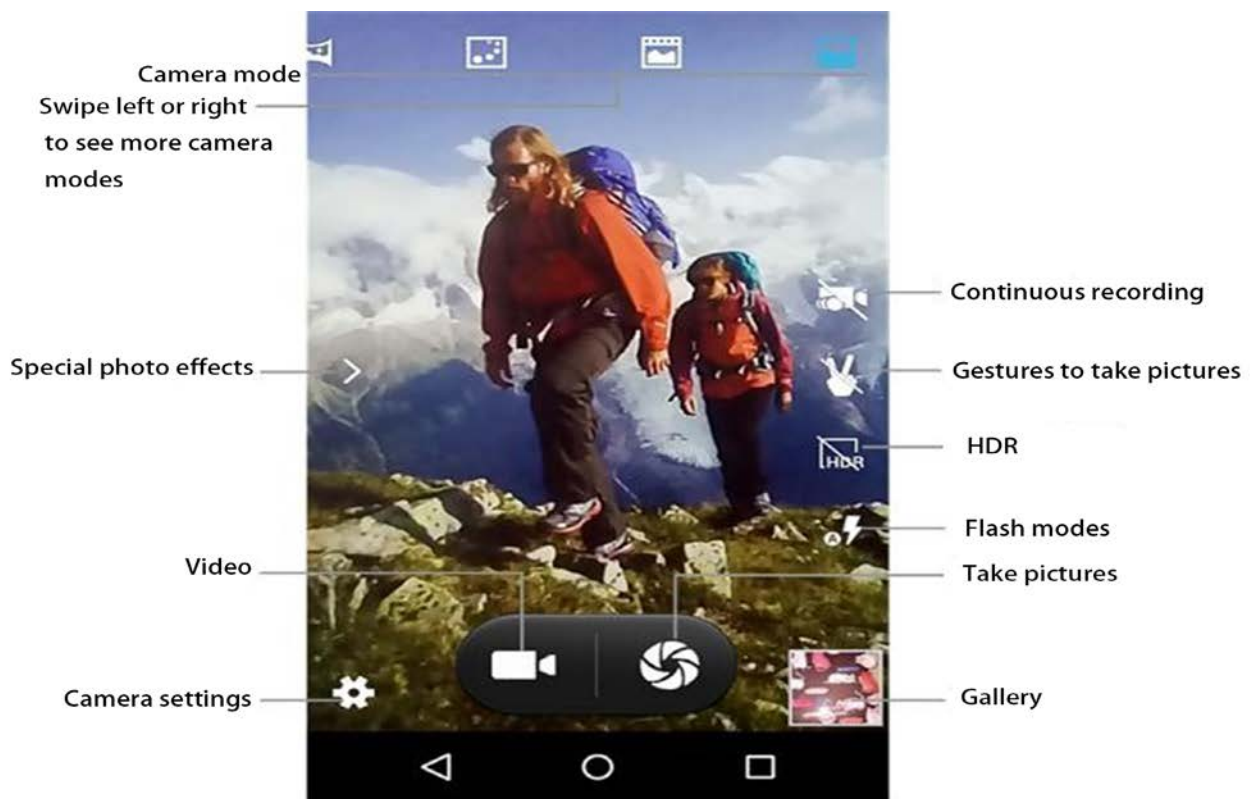

**Continuous recording:** Open the recording can be performed repeatedly.



## Set the language

The default display language is English. Brush to upgrade the system version or restore the factory settings, the system display the language back to the default settings.

Can be put into the local use of telephone card changes, or enter the system settings changes.

Touch the Settings icon  or .

Proceed as follows:

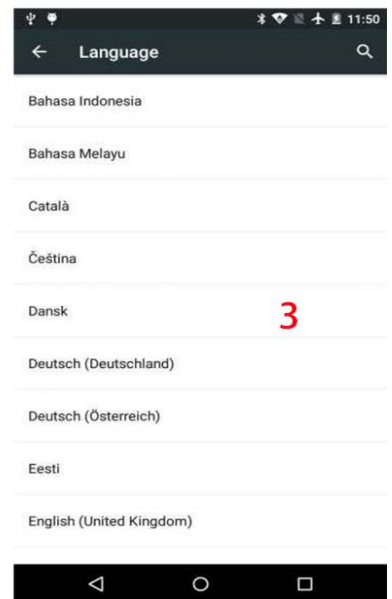
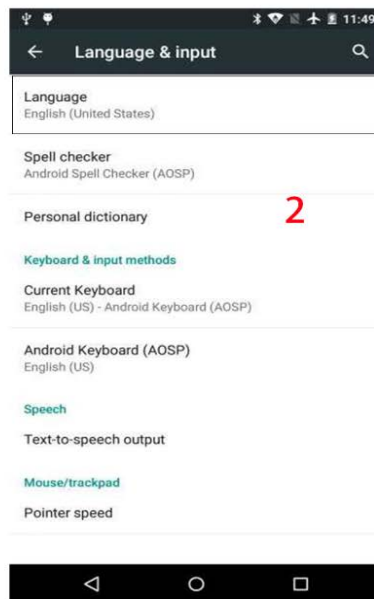
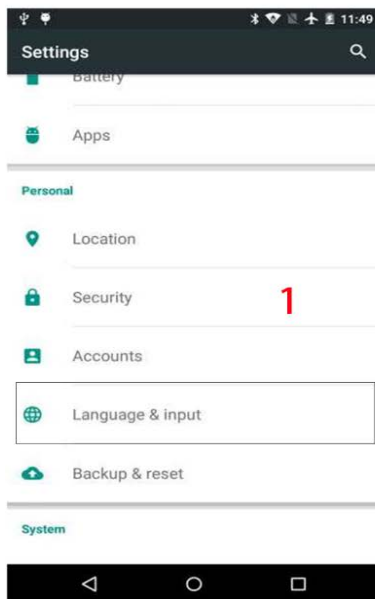

## A key scan

A key scan is also called quick scan. This feature allows you to directly bar code or two-dimensional code scanning, hereinafter referred to as bar code.

### A key scan settings

The device does not open a key by default, you want to use the need to open and set.

**Settings**→**Accessibility**→**Reported Scan key** contains all the relevant options.

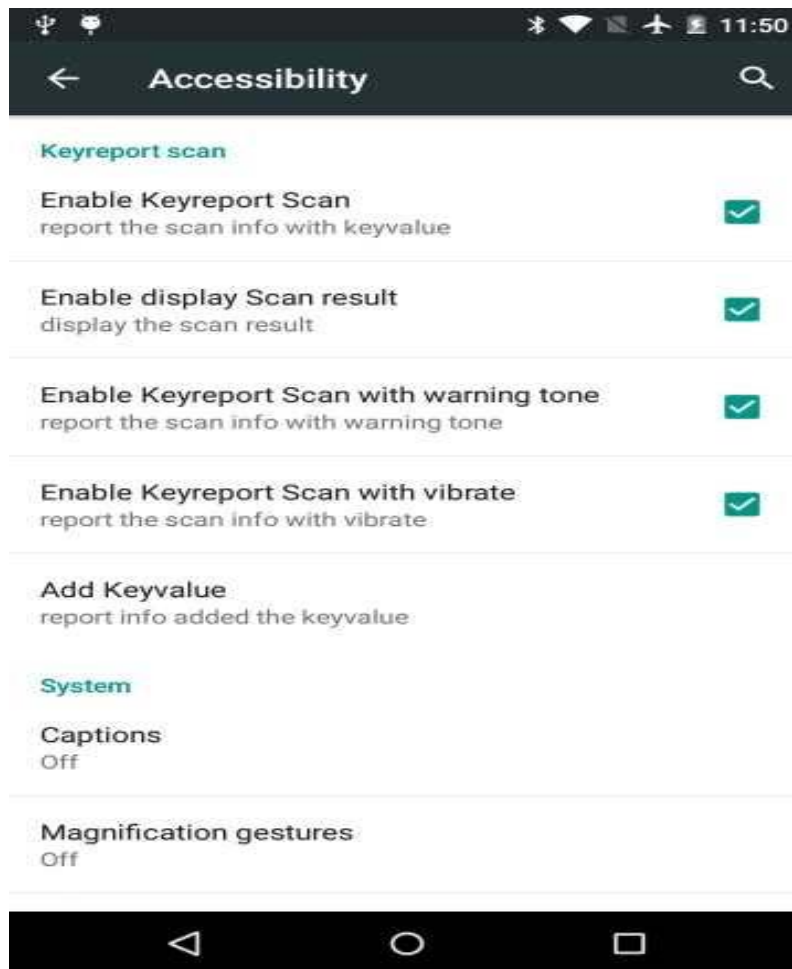

Check **Enable reporting Scan key** to open a key scan function.

**Enable Display Scan Results:** checked by default, scan the bar code successfully reported and displayed information is displayed at the current cursor position; is not checked, then any reported success but does not display the bar code information can be determined display position themselves in specific applications and the way.

**Enable scanning tone:** When checked after scanning you will hear “ding” sound.

**Enable scanning shock:** When checked in after a successful scan machine will vibrate.

## Include key-values

**Include key:** in the back of the bar code information display included with the other key, the default is "without warranty key." "With enter key" After the success of the scan with enter carriage return line feed, "with tab key" after the success of the scan tab to the next tab stop.

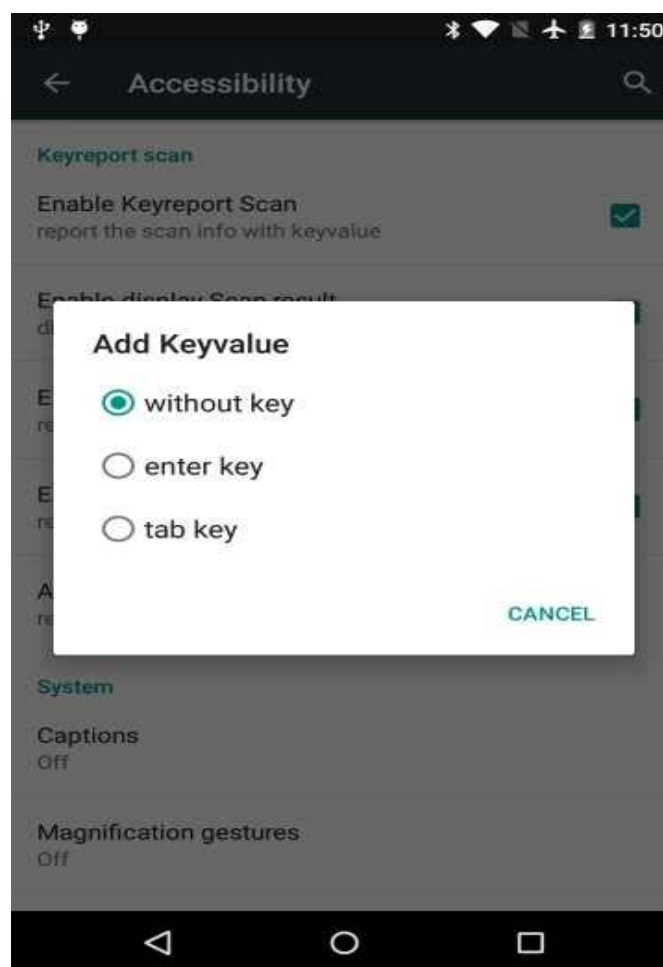

About "Enable display scan results" and "Include key values":

**Check the "enable display scan results", that is reported and displayed bar code information, bar code information will be attached to the key value;**

**Do not check the "Enable display scan results", that is, only reported but does not display the bar code information, will not be accompanied by key values**

## Instructions

Use one-touch scan to set the operation steps are as follows:

**First**, a quick scan opens. Please enter the settings → accessibility, check the "Scan key reporting" category under the "Enable reported Scan key." You can see the scanning beam by pressing any of the scan keys (the scan key on the keyboard or the scan key on both sides of the screen).

**Then**, enter the bar code display interface. Open any available display interface and specify the focus, such as: Message, "To-do" and add new items and "Search" on the desktop.

Finally, a quick scan is performed. Press and hold the scan key and align the scanning beam at the barcode. After the scanning, the head light will be off, and the corresponding bar code information can be seen on the device. **Depending on the version, the scan is divided into two cases: press and hold the scan button that is scanning light, release that is off; click the scan button appears scanning light, sweep to the bar code or more than the scan time exterminate.**

(If you want to hear a tone or vibrate after scanning successfully, you need to check the corresponding "Enable scanning tone" and "Enable scanning vibration".)

## RFID Read (optional)

When the user is based on the terminal to do RFID related application development, please contact the terminal manufacturers to ask for the relevant development documents and sample code.

## Basic model description

Serial number	Model	Configuration instructions
1	S	Standard configuration, WIFI/BT/GPS/4G
2	C13M	Rear 13 million pixels
3	C5M	Front 5 million pixels.
4	N6603	Honeywell N6603 2D scanning head
5	IRIS	Iris Recognition
6	TCS1	Key board to increase the TCS1 fingerprint + decoder board models, Replace the right side of the fuselage button.
7	TCS1G	Key board to increase the TCS1G golden fingerprint head models, Have FBI certification, Replace the right side of the fuselage button.
8	TCS1B	Key board to increase the TCS1B black fingerprint head models, Replace the right side of the fuselage button.
9	R91	PN547 NFC modular.
10	R6	RC663 RFID modular. (And the R91 module does not exist.)
11	UR2K	R2000 UHF RFID modular.



## Special custom instructions

Our equipment reserved a variety of interfaces, can meet the various functions of the custom. For example: RS232,I2C,RS485, etc. Please contact us for details.

## Technical Support Contact

E-mail: [support02@speedatagroup.com](mailto:support02@speedatagroup.com)

Skype: android.speedata